

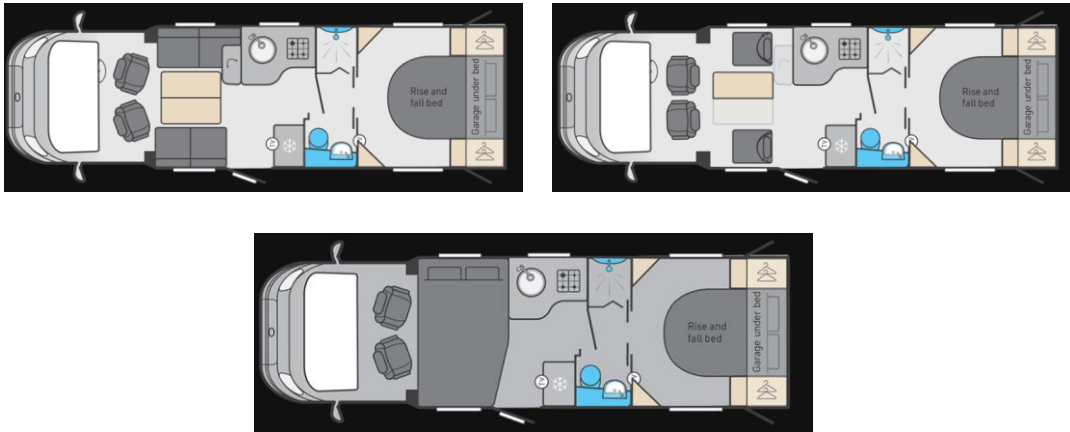

Swift Kon-Tiki 794 (2025)



For the 2025 season, Kon-Tiki showcases significant improvements and advancements aimed at elevating the premium line-up even further. With the introduction of a striking new Fiat cab in Black Metallic, complemented by a revamped exterior graphics scheme, Kon-Tiki is once again setting the standard for luxurious motorhomes.

There are six models available for 2025, including three single and three tag axle, each featuring a garage with services. The versatile lounge design incorporates foldaway Aguti travelling seats with convenient travel cup holders, and an electric rise and fall table. Two models feature an electric drop-down bed for an elegant, practical space.

Enhancing the driving experience, the updated cab design includes a chrome-trimmed dashboard with a 10" touchscreen HD color display and satellite navigation, alongside cruise control, air conditioning, and strong connectivity via built-in 5G Wi-Fi. Parking is made easier than ever with rear reversing sensors paired with twin reversing cameras.

Long journeys are more enjoyable thanks to the new Euro 6E 180bhp engine paired with an 8-speed automatic gearbox, as well as on-board fresh water and waste water tanks with level sensors. An integrated 120W solar panel provides sustainable energy wherever the road takes you, with tag axle models featuring two 100W panels.*

This season, the Kon-Tiki's interior is rejuvenated with the new Cinnamon soft furnishing scheme, offering a fresh, modern look. The washrooms feature shower tray duckboards and a chrome mixer tap, adding extra touches of luxury throughout.

The impressive specification also includes Alde heating, the Swift Command control system with a 7" touch panel, and the Swift Command Tracker, a Thatcham Category S7 approved proactive tracker (subject to annual subscription).

Built on Swift's pioneering SMART construction platform with a timberless upper bodyshell and durable GRP outer skin, Kon-Tiki continues to offer outstanding build quality, backed by a 10-year bodyshell warranty.**

* Two 100w solar panels on tag axle models

** Subject to terms and conditions.

- European Whole Vehicle Type Approval ensures compliance with strict weight, dimensions and safety regulations
- **NEW** Fiat chassis cab in Black Metallic, with **NEW** updated front grille and body coloured bumper
- AL-KO low line 4500kg MTPLM chassis conversion with wide rear track (5000kg MTPLM on 874, 884 & 894)
- EN 1646-1 Grade 3 classification for heating and thermal insulation, for sub-zero ambient temperatures, confirmed by cold chamber testing
- **NEW** Euro 6E 180bhp, 2.2 litre engine with **NEW** 8-speed automatic gear box with ESC pack and Eco pack
 - ESC Pack: Traction+ anti-slip regulation (ASR), roll over mitigation (ROM) and hill descent control
 - ECO Pack: stop/start system, smart alternator and more efficient energy saving fuel pump
- 90L fuel tank and Ad-Blue based after treatment system with 19L tank
- SMART construction with full GRP bodyshell:
 - Strong, moisture proof 'PURE' Polyurethane timberless framed body shell with HD polystyrene insulation core
 - Balanced panel 31mm sandwich side walls with GRP outer and inner skin
 - 44mm sandwich floor construction, with GRP outer skin, ply upper and high rigidity Styrofoam core
 - 31mm sandwich construction hail resistant exterior GRP roof, fully bonded for extra strength and flatness, and GRP inner skin
- GRP front low line pod with electric opening Skyview panoramic sunroof
- White extruded skirts link with full height GRP rear panel
- Distinctive streamlined exterior front profile
- **NEW** exterior graphics scheme coordinated with cab
- Daytime running lights
- Stylish 16" alloy wheels
- Fix 'n' Go puncture repair kit

- Low energy LED lighting
 - Exclusive front marker lights
 - Side marker lights
 - Exclusive rear light clusters
 - High-level brake light
 - Exterior awning light
 - Additional offside exterior light
- 120W solar panel
- External 230V socket
- External BBQ point
- External cold water shower point
- Wide habitation door (600mm) with window, flyscreen, bin, umbrella stand and central locking
- Rear garage with Metallic Grey Chequer lino, lighting, heating, sockets and hanging provision, with access doors on both sides
- Two pull-out underfloor pannier lockers
- Provision for 1 x 6kg and 1 x 13kg gas bottles with fitted butane / propane regulator and propane hose
- Flush fitting, double glazed, tinted acrylic windows with night latch ventilation
- Thule T4200 series roll out awning
- Twin reversing cameras with 7" LCD screen rear view mirror and rear reversing sensors
- Heavy duty rear chassis members ready for optional towbar
- Bike rack fixing rails fitted to the rear
- Dashboard design with chrome trim including:
 - Leather steering wheel with steering wheel controls including volume control and phone compatibility
 - Gear lever with leather gaiter
 - Full digital dash cluster with 10" information display
 - Cab light, back lighting & floor lights
 - Fiat Sat Nav with TomTom 3D map visualisation and selectable vehicle dimensions
 - DAB radio with Apple Carplay™ / Android Auto™, USB and Bluetooth
 - Central area with pocket for smartphone, double USB socket and cup holders
 - Door pockets with bottle holder
 - Cruise control
 - Driver and passenger airbags
 - Automatic cab air-conditioning
- Wireless phone charger
- ABS brakes
- EBD (electronic brake force distribution)

- Immobiliser with rolling code
- Variable power steering
- Electrically adjusted and heated wing mirrors fitted with direction indicators and DAB radio aerial
- Electrically operated and tinted cab windows
- Adjustable headlamp height
- **NEW** Front fog lights
- Adjustable steering wheel position
- Pleated cab blinds (windscreen and side blinds)
- Removable and bleachable cab carpet
- Driver and passenger captain chairs both with:
 - Position, height and rake adjustment
 - Swivel base
 - Two armrests
 - Integrated headrest
 - Fully upholstered covers
 - Seat base surrounds
- **NEW** Ultra-leather® Cinnamon soft furnishing scheme with complementary scatter cushions
- Decorative Sangallo Elm woodgrain with complementary Oxford Tajet, Toro Tela and Grau furniture
- Cream/Pearl gloss, soft-close upper locker doors with dual chrome inlays
- Grey French Oak effect, high impact, scratch resistant floor
- Sectioned removable and bleachable carpets
- Removable stepwell mat
- Entrance doorway feature panel with illuminated grab handle
- Front parallel lounge with fold-down Aguti travelling seats incorporating ISOfix
- Travel seat cup holders, accessible when Aguti travelling seats in position
- Lap and diagonal seat belts on all designated passenger seat
- Ergonomically contoured bedding for increased comfort, wrapped in Ultraleather Cinnamon, a high performance fabric meticulously designed with ultimate softness and durability, and finished with quilted stitch detailing
- Seat backrest ventilation boards
- Lounge bench seat cushions and bed mattresses supported by beech slats for extra comfort (model specific)
- Exclusive Duvalay Duvalite Alto mattress, which includes a platinum support layer and reflex foam for superior durability, while memory fibre increases airflow for a more comfortable sleep (fixed and drop down beds)
- Magnetic retention to centre walkthrough door

- Sliding doors with latches and locks on bedroom door
- Rise and fall rear island bed to provide greater storage when travelling
- Pleated cassette blinds with flyscreens on all windows
- Easy action concertina door flyscreen
- Decorative blind and flyscreen surrounds
- Midi-Heki rooflight with flynet and adjustable blinds in bedrooms
- Built in Wi-Fi via boosted 5G/4G/3G signal, includes 'Smarty' SIM
- Improved black branded speakers (model specific)
- Increased head height (2110mm)
- Thetford thermostatic oven and separate grill, plus a dual fuel three-burner hob with 1x 800W electric hotplate, all with electric ignition. Hob features a glass lid with automatic gas shut-off functionality
- Dometic built-in flatbed microwave with digital controls
- Dometic (Series 10) 133 litre, tall slim-line, dual hinged, automatic energy selection fridge with 230V, gas and 12V operation incorporating 12 litre removable freezer compartment
- Dometic (Series 10) 177 litre, dual hinged automatic energy selection fridge/freezer with 230V, gas and 12V operation
- Washing-up bowl
- Kitchen unit featuring a bank of drawers, including a large cutlery drawer and deep pan drawer with soft-close runners
- Thule omnivent in kitchen/washroom area
- Cream high gloss kitchen cabinets with removable shelves
- Beige Weft laminate kitchen worktop with textured finish and black edging with durable underslung stainless steel sink
- L-shaped sink unit with foldaway kitchen worktop extension
- Chrome effect Karina kitchen mixer tap
- Illuminated printed acrylic splashback
- Removable drainer and food grade nylon chopping board nestle together for easy storage
- Mapa electric rise and fall table
- Washroom design with vanity unit, sink, toilet and separate shower
- Dedicated shower cubicle with shower mixer tap, riser bar, soap dish and integrated storage shelf for toiletries
- Quadrant shower lighting
- Ecocamel Jetstorm showerhead with on/off button for a powerful shower that uses less water
- Shower tray duckboard
- Crema Bianca marble effect wallboard and concrete effect sidewall GRP in shower with Tournai Stone floor vinyl on raised floor in vanity area
- Gloss white vanity bowl and marble effect worktop with back-lit vanity mirror and improved chrome effect mixer tap

- Thetford C260 swivel cassette toilet with electric flush and 18 litre wheeled tank
- Fold-down shower garment rail
- Micro-Heki skylight with flyscreen and blind in washroom
- 32mm thick entrance door with decorative inlay, domestic style mortice lock and handle
- Shaver socket
- Illuminated mirror
- Positive overhead locker catches for secure storage on the move with chrome handles
- Spring-assisted lounge seats and bed tops for easy storage access (except travelling seats)
- Moulded over-cab storage compartments with Skyview opening sunroof
- Upper and lower cupboard storage in washroom area
- Exclusive Swift Command control system with large 7" LCD colour touchscreen panel with improved user interface and functionality featuring;
 - Simple controls for monitoring and managing:
 - Power
 - Battery selection, battery level meter and power usage
 - 230V AC load limiter (settable between 5 amps & 16 amps)
 - Solar panel charging levels (where fitted)
- Heating control of Alde system
- Environment monitoring with internal and external temperature and internal humidity levels
- Lighting control
- Water system controls, tank levels and control of tank drain valves
- Air-conditioning compatible with Dometic and Truma (dealer fit option, model specific)
- Fridge control via CI-BUS connection
 - Pre-installed Swift Command Tracker, a Thatcham Category S7 approved proactive tracker (subject to annual subscription)
 - Updated Swift Command app enabling you to manage and monitor key vehicle functions from your mobile device including power, heating and selected lighting:
- Incorporates a simpler connectivity selection:- Bluetooth connectivity when with the vehicle- Wi-Fi / GSM connectivity when away from the vehicle (subject to network coverage)
 - Includes the useful 'Places of Interest' feature including 'Campsites' from the Camping & Caravanning Club and Swift dealership locations

- Alde dual fuel radiator central heating and water heating with daily programming
- Alde LCD control panel with 1kW, 2kW or 3kW settings
- Alde circulation pump with 5 speed settings
- Zonal control of Alde heating
- Truma 'Crash Sensor Duo' regulator for en-route use of heating and water heating
- Pressurised fresh water system with self-priming pump and accumulator
- 12V exterior power point for pump filling of water tank (pump not supplied)
- 110 litre underfloor mounted fresh water tank with level sensor
- 85 litre underfloor mounted waste water tank with level sensor
- Electronically operated drain valves on fresh and waste water tanks
- Winter Pack with waste water tank heater with en-route heating to keep defrosted, insulated drain valve covers and fridge vent covers
- Fully sealed, long life, 100 Amp-hour (Dir 2006/66/EC) leisure battery
- Mains 230V supply via easy-access consumer unit to sockets, fridge, microwave oven, boiler and battery charger/transformer
- 25 metre mains hook-up cable
- 25 Amp/300W charger/transformer for leisure batteries
- Ultra-low energy LED lighting system:
 - Spotlights with USB sockets
 - Over-locker ambient lighting
 - Illuminated lower locker profile
 - Adjustable cab reading lights
 - Wardrobe light
 - Low-level night lights
 - Dimmable interior light
- Minimum of eight 230V chrome sockets (including two in cab area and one in the garage)
- Wireless phone charger pad on doorway feature panel
- Dedicated USB points
- USB socket for rear passenger seats
- Status 570 TV aerial
- TV points with 230V and 12V sockets and aerial socket
- VIN CHIP™ identification system concealed within construction to deter theft and aid quick recovery
- Single key for all habitation doors
- Key fob operated remote central locking of cab doors and entrance door
- Smoke alarm
- Carbon monoxide alarm
- Manufacturer backed 10 year bodyshell warranty

Factory fit

- Detachable homologated tow bar and electrics
- Hydraulic automatic self-levelling system
- Air suspension
- Hydraulic automatic self-levelling system & air suspension
- Drop bed option in place of lockers over front lounge (884 & 894)

Dealer fit

- Thule Elite G2 two cycle rack*
- Swift Command Tracker by Sargent annual subscription

* Dependent on model, visibility through rear camera may be reduced when bicycles are carried on the optional bike carrier