

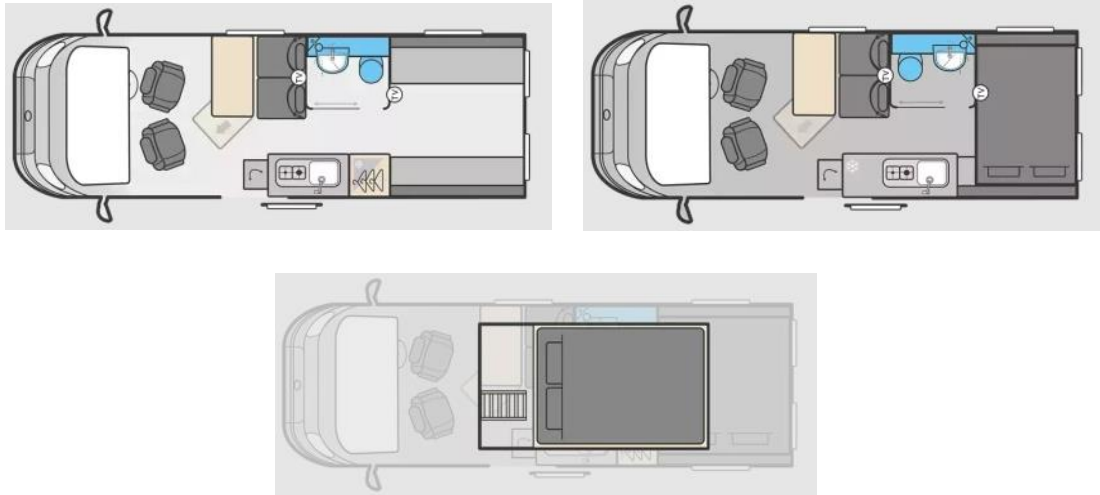

Swift Trekker X (2025)



- European Whole Vehicle Type Approval ensures compliance with strict weight, dimensions and safety regulations
- NEW Ford Transit panel van in Grey Matter with improved front suspension and brake modules.
- Elevating roof in body colour (Trekker & Trekker X)
- Gloss black spoiler at the front (Trekker & Trekker X)
- NEW Euro 6E 165bhp, 2.0 litre TDCi EcoBlue engine with 6-speed manual transmission
- Black bumper/external panels with eye catching graphics
- 70L fuel tank and AdBlue based after treatment system with 21L tank
- Whale external cold water shower point with hose and head
- Whale external BBQ point with connection nozzle
- NEW Stylish design 16" alloy wheels in matt black with all-weather tread tyres
- Tyre Pressure Monitoring System
- Rain guards to all wheels
- Tyre repair inflation kit
- Low energy LED lighting
- NEW 110W solar panel and regulator
- Provision for 2 x 6kg gas bottles with fitted butane/propane regulator and propane hose

- Flush fitting, double glazed, tinted acrylic windows with night latch ventilation
- Rear Ford glazing with privacy glass
- All models have a MTPLM of 3500kg and can be driven on a normal category B driving license
- Dashboard design including:
 - NEW Ford Sync 4 bringing you a more seamless, more connected, more personalised driving experience. Features include DAB/FM RDS Radio with Apple Carplay™ / Android Auto™, USB, Bluetooth and rear parking aids Steering wheel with steering wheel controls
 - Dash with lockable glove box, storage trays on top and cup holders
 - 1 x 12V sockets and USB socket in centre
 - Internal door panel with map pockets
 - NEW digital dash
 - Cruise control
 - Driver and passenger airbags
 - Automatic cab air-conditioning
 -
 - Electronic Stability Programme (ESP, HLA, FBS) with Curve Control, Load Adaptive Control (LAC) and Roll Stability Control (RSC)
 - Emergency Brake Assist (EBA) and emergency brake warning
 - Immobiliser – Safeguard Passive Anti-Theft System (PATs)
 - Electric power-assisted steering (EPAS)
 - Lane keeping system
 - Eco stop/start system
 - Electronic parking brake
 - Front fog lights
 - High Series Halogen cornering headlamps with automatic headlamp control
 - Daytime running lights
 - Front and rear parking aid
 - NEW Digital Rear View Camera
 - Wide dual power heated signal mirrors
 - Automatic windscreen wipers
 - Electrically operated and tinted cab windows
 - Adjustable steering wheel position
 - Overhead shelf console
 - Concertina cab blinds (windscreen and side blinds)
 - Driver and passenger captain chairs both with: Position, height and rake adjustment
 - Swivel base
 - Two armrests

- Integrated headrest
 - Fully upholstered covers
 -
 - Oceania soft furnishing scheme featuring stain resistant, easy to clean fabrics
 - Sangallo Elm woodgrain with complementary Toro Tela furniture
 - White and Kashmire locker doors with chrome inlay and concealed handles.
 - Overhead locker construction with full length LED strip lighting in the roof mounted header rail
 - Zip pocket storage over the front side locker (Trekker & Trekker X)
 - Dark grey Savoy fabric wall covering with stain resistant finish on lower panels
 - Ancares Oak Plank effect, high impact, scratch resistant floor
 - Loose fit bleachable habitation carpets (in front lounge only on Trekker & Trekker X)
 - Forward facing travelling seats with 3-point seat belts, ISOFix connections on aisle seat and armrest to side wall, incorporating USB socket (Trekker & Trekker X)
-
- Midi-Heki skylight with flyscreen built in to the elevating roof (Trekker & Trekker X)
 - Double glazed windows with pleated cassette blinds and flyscreens
 - Rear windows with blinds and flyscreens
 - Anthracite interior formed décor panels to sliding and rear doors
 - Exterior sliding door flyscreen
 - Rear door panels featuring folding storage table and door pockets
 - Moulded window surrounds and storage pockets in contrasting Diamante fabrics
 - Naturewall decorative panels down centre of roof with LED strip lighting (continues on end of Trekker sink unit and Trekker XL wall panels)
 - Front overcab surround with door section to match front side lockers and overhead storage trays
 - High-level fold-away rear beds allowing storage down the centre (Trekker & Trekker X)
 - Rear lounge seating with angle seats for more storage (Trekker XL)
 - Exclusive Duvalay Duvalite Alto mattresses on rear beds, which includes a platinum support layer and reflex foam for superior durability, while memory fibre increases airflow for a more comfortable sleep (Trekker & Trekker X)
 - Upholstered headboard to the nearside (Trekker & Trekker X)
- Elevating roof system featuring: (Trekker & Trekker X) Secure twist lock closing system

Dual zipped windows complete with midge screens
Fire resistant tent fabric
Folding mechanism that pulls canvas away from hinges on closing
Double bed with bed springs for added comfort and fall-out protection
Moulded roof hatch with lighting and USB points
Halo roof lighting around the canopy
Folding bunk ladder

Roof mounted speakers
Combination Dometic two-burner stainless steel hob and sink with glass lids
NEW built-in oven with grill (Trekker X & Trekker XL)
Appia laminate kitchen worktop
Dometic 50 litre compressor fridge (70 litre with double hinge for improved access on Trekker X & Trekker XL)
Rotating fold-out worktop extension (Trekker)
Lift-up worktop extension (two on Trekker XL)
Removable table with folding leg in front lounge (Trekker & Trekker X)
Desmo table at rear (Trekker XL)
Washroom and shower tray with foldaway washbasin and separate vanity tap
Shower mixer with Ecocamel Jetstorm shower head and retainer, with on/off button for a powerful shower that uses less water
Tambour washroom door
Upper vanity cupboard with mirror, LED lighting and decorative panel
Thetford cassette toilet with electric flush and 18 litre wheeled tank and concealed waterproof toilet roll holder
Wooden duckboard
Positive concealed locker catches throughout for secure storage on the move
Pan storage and cutlery drawers in kitchen with soft-close runners
Load compartment tie-down rings (Trekker and Trekker X)

- Control system with 4" LCD colour touchscreen panel featuring;
Power
- Battery selection, battery level meter and power usage
- Selected lighting control with soft-start dimming
- Water, tank levels and control related features such as pump control
- Environment monitoring with internal and external temperature and internal humidity levels
- Simple controls for monitoring and managing:
-
- Whale heating with blown air distribution around van

- Whale internal 8L water heating system
 - Control panel fascia for heating and hot water
 - Truma 'Mono' regulator
 - Pressurised fresh water system with self-priming pump and accumulator
 - 12V exterior point for pump filling of water tank (pump not supplied) incorporated in the Whale water inlet housing
 - Insulated 65 litre fresh water tank
 - 55 litre waste water tank
 - Electronically operated fresh and waste water drain valves with insulated covers
 - Large bore underslung rigid waste pipes
 - Winter Pack including tank heaters and pipe insulation
 - Fully sealed, long life, 100 Amp-hour (Dir 2006/66/EC) leisure battery
 - Mains 230V supply, via easy-access consumer unit, to sockets, fridge, heater, water heater and battery charger/transformer
 - 25 metre mains hook-up cable
 - 25 Amp/300 Watt charger/ transformer for leisure batteries
 - Ultra-low energy LED lighting system throughout interior including:
 - Ceiling LED strip lights
 - Over-locker LED ambient lighting
 - Under-locker spotlights
 -
 - Minimum of four chrome 230V sockets and dedicated USB points
 - USB socket in armrest rear passenger seats
 - Co-ax TV connection in the external mains inlet socket for external source
 - Two TV points with 230V and 12V sockets and aerial socket (one on Trekker XL)
 - Black branded speakers fitted in roof at rear
 - VIN CHIP™ identification system concealed within construction to deter theft and aid quick recovery
 - Key fob operated remote central locking
 - Smoke alarm
 - Carbon monoxide alarm
- Factory Fit
- NEW 165bhp, 2.0 litre TDCi Ford EcoBlue engine with 8-speed automatic transmission with NEW rotary shift gear selection